

8014

Wireless table / wall button

2014-06-10 - V1.0



User Manual

General:

The wireless table / wall button alarms when a person presses the button. The button can be easily placed on a table or can be mounted on the wall. There is an option inside to flash a weak light behind the button every 2 seconds. In this way it can be easily found in the dark. To prevent fall presses you can choose to change the settings so that the button needs to be pressed for 2 seconds before it alarms. This button can be used in combination with all the Daza receivers and pagers.

Opening the device:

Remove the screw on the side of the cover.

Rotate the cover until it stops and lift the cover.

Preparing for use

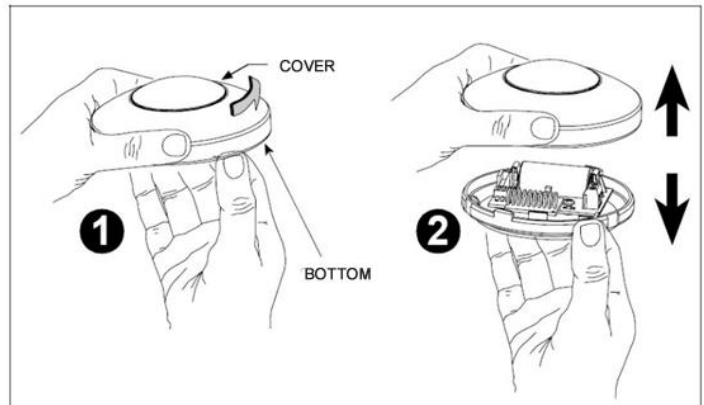

Figure 1: Opening the button

Battery placement:

Place the battery as indicated in figure 2.

Pay attention to the polarity of the battery, plus (+) & minus (-).

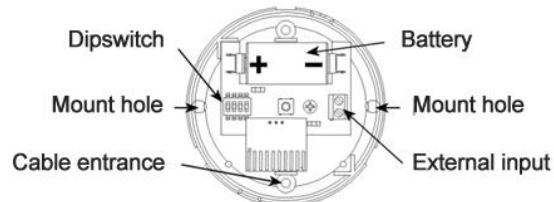

Figure 2: Battery placement and dipswitches

Warning!

If you replace the battery with an incorrect battery type, the 8014 can be damaged.

Dispose of used batteries according to local regulations.

Function settings

The 8014 has 4 dipswitches which corresponds to the following settings:

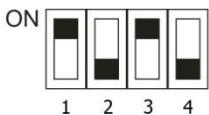

Switch	Function	Stand	Option
1	Background flashing light red button	On*	Backlight on
		Off	Backlight off
2	External input	On	End of line (47KΩ)
		Off*	Normally Closed
3	Restore message external input	On*	Message on
		Off	Message off
4	Press time red button	On	2 seconds
		Off*	300 milliseconds

* = standard settings

8014

Wireless table / wall button

2014-06-10 - V1.0



User Manual

Installation

Connecting external input

An external component can be connected with 2 wires on the external input. Pay attention that it needs to be a normally closed contact (NC).

Inleren

The 8014 must be programmed into a receiver or Pager so that it can communicate with them. If the external input is used, it must be programmed separately from the button as a unique transmitter. Refer to the manual of the corresponding receiver how to program the 8014.

Specifications

Frequency (MHz): 869.

Electronically

Internal Battery: 3V battery type CR123

Note: Dispose of used batteries according to local regulations.

Power consumption: 35 mA (in alarm), 20µA in idle.

Battery lifetime: approximate 5 years (with one alarm a day)